

23  
46  
80  
157

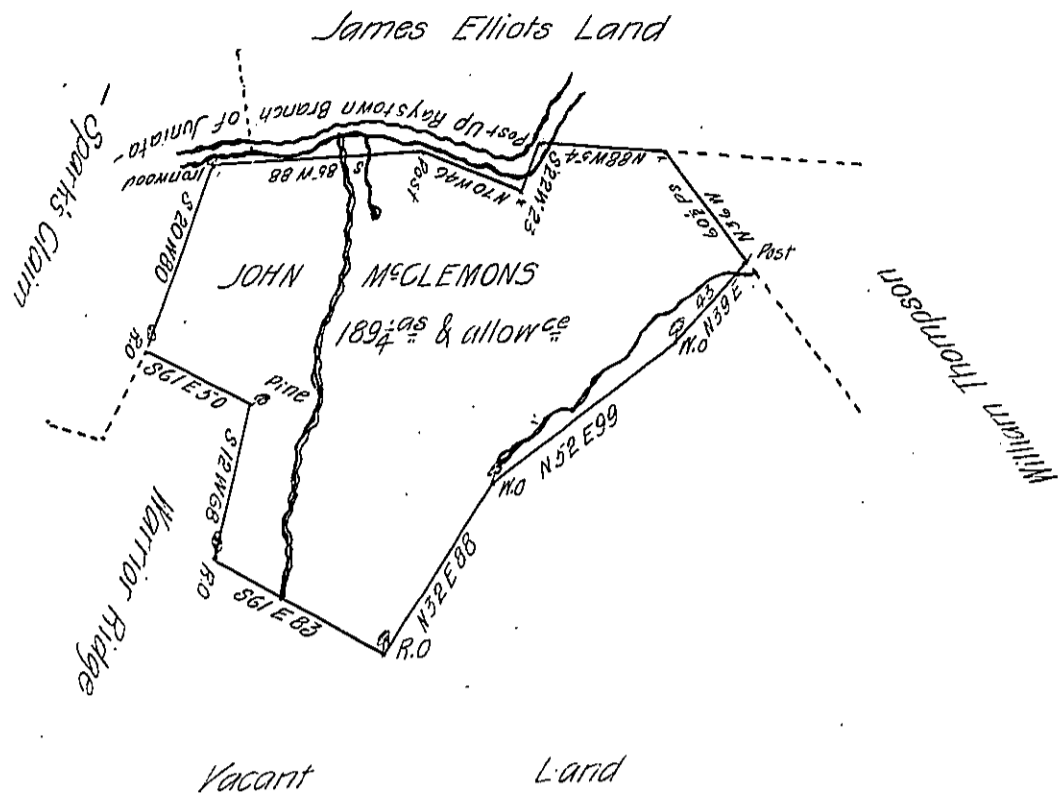

A draught of a tract of land situate on the Paait side of the Raystown Branch of Juniata in Providence township in the County of Bedford. Containing one hundred and eighty nine  $\frac{1}{4}$  acres with the usual allowance of six Per Cent for Roads &c. Surveyed for John McClemons the 25<sup>th</sup> day of June 1788. In Pursuance of a Warrant dated May 7<sup>th</sup> 1787.

George Woods D.S.

To John Lukens Esq. S.G.

IN TESTIMONY that the above is a copy of the original remaining on file in the Department of Internal Affairs of Pennsylvania, made conformably to an Act of Assembly approved the 16th day of February, 1833, I have hereunto set my Hand and caused the Seal of said Department to be affixed at Harrisburg, this twenty sixth day of February 1906

*George Woods*  
Secretary of Internal Affairs.